



ETHAN ALLEN®

— THE INTERIOR DESIGN DESTINATION —

ELEVATE
YOUR HOME
WITH ETHAN ALLEN
QUALITY, DESIGN & VALUE

36-MONTH
FINANCING^{\$}

SAVE UP TO 20%*

SEE BACK FOR DETAILS

HANDCRAFTSMANSHIP MAKES ALL THE DIFFERENCE

featuring the Bridgers sofas & Fairfax chairs

For 93 years and counting, Ethan Allen furniture has been made in North America and celebrated for top-tier quality. **Paired with our complimentary interior design service, it's a value like no other—prepare to say “wow” every time you walk through the door.**

HIGH STYLE

Fit for the royalty of the house—you—this breathtaking bedroom features our custom **Elenora bed**, hand-tailored in our North American workshops in the fabric or leather of your choice.

36-MONTH
FINANCING^{\$}

SAVE UP TO 20%*

SEE BACK FOR DETAILS

36-MONTH
FINANCING^{\$}

SAVE UP TO 20%*

SEE BACK FOR DETAILS

JUST EXQUISITE

Our **Aelin dining table**, **Chrystiane chairs**,
and **Villa display cabinet** are all made in
North America—you choose the finishes
and fabrics that suit your style.



HAVE YOUR HOME DESIGNED BY ETHAN ALLEN



ETHAN ALLEN'S INTERIOR DESIGNERS MAKE FURNITURE RECOMMENDATIONS AND 3D ROOM PLANS. THEY MANAGE ORDERS, ORCHESTRATE DELIVERY DAY, AND OFTEN BECOME FRIENDS FOR LIFE—AT LEAST, THAT'S WHAT OUR CLIENTS TELL US.

Drop into a Design Center and let an Ethan Allen designer show you around. Tell them what furniture you like and which colors, fabrics, and accessories really speak to you.

From there, your designer can visit your home to explore its architectural features and get a sense for how you want to live in the space. They'll craft a personalized presentation, including an incredible 3D preview of their proposed design, and work with you until the details are just right.

Our designers help clients who are growing their families or downsizing. They help property developers and realtors turn blueprints into showplaces. **From first conversation to delivery day, their help is complimentary—and you'll love the results.**

36-MONTH
FINANCING^{\$}
SAVE UP TO 20%*
SEE BACK FOR DETAILS

RELAXED LIVING

featuring the Odell sofa & Calia swivel chair
Casual rooms like these create freedom to bend the rules of design—to beautiful effect. Here, we play with symmetry by adding a modern-leaning swivel chair to a more formal seating arrangement.



A BREATH OF FRESH AIR

Simple. Rustic. Beautiful. Sometimes, a few words are all you need to describe a bedroom like this, where our **Continental bed's** farmhouse-inspired silhouette, distressed wood finish, and custom upholstered insert are just right.

36-MONTH
FINANCING^{\$}

SAVE UP TO 20%*

SEE BACK FOR DETAILS



NATURAL LIGHT

Dakota, a lightly distressed finish, lets our **Piermont table's** natural texture shine; our **Fairlee buffet** effortlessly adds serving and storage space.



36-MONTH
FINANCING^{\$}

SAVE UP TO 20%
SEE BACK FOR DETAILS

HOME OFFICE CHIC

Yes, that's our **Villa bookcase** in a statement-making black finish. Its classic details take on a reclaimed treasure vibe that complements the timeless shaped legs on our custom desk.

36-MONTH
FINANCING^{\$}
SAVE UP TO 20%*
SEE BACK FOR DETAILS

QUALITY THAT STANDS THE TEST OF TIME

WE MAKE ABOUT 75% OF OUR FURNITURE IN OUR NORTH AMERICAN WORKSHOPS, CARRYING ON THE STANDARDS OF CRAFTSMANSHIP AND EXCELLENCE THAT HAVE MADE US A HOUSEHOLD NAME.



When you purchase wood furniture from us, our craftspeople use wood sourced from responsibly managed Appalachian forests. They kiln-dry the wood, mill it, and use it to shape and assemble each piece, finishing your furniture by hand.

Purchasing upholstery? Our craftspeople use only fabrics and leathers chosen for their exceptional beauty and quality; you can even customize cushion comforts and add the trims of your choice. Every piece, every time, our craftspeople will make it to order, just for you.

Enjoy all the quality and personalization of a custom furniture house, offered at an incredible value. **It's why people have made Ethan Allen a part of their homes for almost a century.**

GARDEN LOUNGE

featuring our Mylos upholstery

Greek-ish vibes in the garden? Yes, please. Our **Mylos collection** is beautifully made using Plantation Teak and all-weather woven inserts in a goes-with-anything triangle motif.

36-MONTH
FINANCING^{\$}

SAVE UP TO 20%*

SEE BACK FOR DETAILS

AL FRESCO

featuring Bridgewater Cove & Marteena

We love a mix of textures outdoors, too, and that's why our **Bridgewater Cove Plantation Teak dining table** and **Marteena outdoor dining chairs**—with all-weather woven backs and seats—are a perfect pairing.

36-MONTH
FINANCING^{\$}

SAVE UP TO 20%*

SEE BACK FOR DETAILS

SUNROOM READY

featuring Viscaya & Bridgewater Cove

Our outdoor collections like midcentury-inspired **Viscaya** are designed to look beautiful and last for seasons—because rooms that blend indoors and out require extra durability, but no compromises on looks.



36-MONTH
FINANCING^{\$}
SAVE UP TO 20%*
SEE BACK FOR DETAILS

DESIGN THAT GROWS WITH YOU

a custom nursery she'll love for years

Marty Holick
Diamond Spirit Award
Best Use of Custom Soft Goods
in a Space



For a family building their forever home, the design of their baby's nursery posed a unique challenge. Avid travelers, the parents longed to feel planted so their children could grow, and they also wanted the baby's room to be one she would be proud to have friends visit as she gets older.

The couple reached out to award-winning designer Marty Holick, a master of textiles, to help them achieve their vision. To create a beautiful room for one of the most important people in the parents' lives, Marty tapped into our extensive book of custom textile options.

"Every detail matters in this room," Marty tells us. He began with a custom Rania bed, hand-tailored in a soft blush fabric that became the foundation of the room. **"You have a beautiful brush fringe, welting, taping, buttons—it all helps balance the large-scale print on the headboard."**

Even the drapery was custom, and Marty carefully considered every detail there, too. **"With the wallpaper being a pink field with white lines, I reversed it on the drapery. That contrast is what makes these draperies really stand out."**

Having custom pieces crafted, according to Marty, is easier than you think—and **that makes it so simple to design a room a girl can love whether she's one or eleven.**



One thing you just have to know about Marty: He loves color. "A lot of people are on the train of everything being a tone of gray, but we all live in color. Color expresses emotion; for me as a designer, **I know my job is done when you feel something when you walk into a room.**"

If your family is growing or just needs a change, stop by your local Design Center. Designers like Marty are here to look, listen, and create a home that meets your family's needs for years to come.



WE LOVE FUNCTIONAL FASHION

New Donnelly Ottomans

It's a coffee table that doubles as seating in a pinch. Choose from round, square, and rectangular shapes; select your leg style, wood finish, cushion fabric, and add-ons like tufting and nailheads.



36-MONTH
FINANCING^{\$}

SAVE UP TO 20%*

SEE BACK FOR DETAILS



weLOVE A FABULOUS DISPLAY

New Custom Buffet Options

Custom buffets got even more grand—they're now available with an optional upper hutch for displaying china and more. Select open shelving with beadboard backing or tempered glass-panel doors.



36-MONTH
FINANCING^{\$}

SAVE UP TO 20%*
SEE BACK FOR DETAILS

sizes

TWO-DOOR BUFFET
(37"L X 19"D X 36"H)



THREE-DOOR BUFFET
(52 1/2"L X 19"D X 36"H)

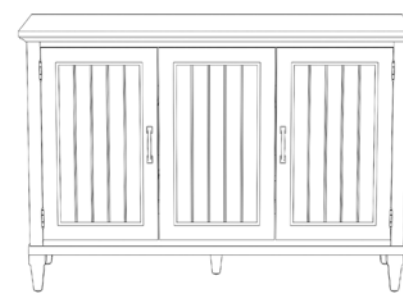

FOUR-DOOR BUFFET
(70"L X 19"D X 36"H)

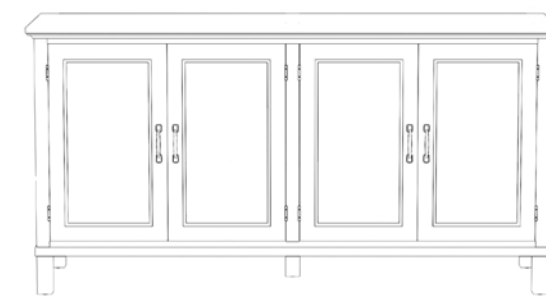

top styles

SMOOTH
(MAPLE SHOWN)



TEXTURE
(OAK SHOWN)



PLAIN



BEADED EDGE



MOLDED EDGE



optional drawer

choose your door styles

BEAD FRAME (WOOD OR GLASS PANEL)



BEADBOARD



MOLDED FRAME (WOOD OR GLASS PANEL)



optional hutch

An upper hutch can be added to any buffet (two-door width shown below).

UPPER OPEN
SHELVES



UPPER GLASS-PANEL
DOORS



foot & hardware styles

PARSONS



PIN



URN



COLLARED



TAPERED



PLINTH



Buffets come standard with Blackened Pewter hardware; for additional options, visit a Design Center.



Faux Florals in Springy Hues

Blush, lilac, cream, even mauve—spring colors are everywhere you look within our faux floral collection, and they're ready to freshen up every surface in your home.



36-MONTH
FINANCING^{\$}

SAVE UP TO 20%*

SEE BACK FOR DETAILS



WE LOVE SPECIAL SOMETHINGS

Decorative Accents

At Ethan Allen, we've done the work of finding beautiful treasures for you. All you have to do is stop by and see what pieces—from vases and bowls to baskets and artwork—inspire you.

36-MONTH
FINANCING^{\$}

SAVE UP TO 20%*

SEE BACK FOR DETAILS



AT YOUR SERVICE

It's as close to magic as it gets—the day your new furniture comes home. We place each piece where you want it, unwrap and assemble as needed, and remove all packaging, leaving your home more beautiful than ever.



36-MONTH FINANCING\$ SAVE 20%

ON FABRIC UPHOLSTERY, BEDROOM, OUTDOOR & SELECT ACCENTS*

SAVE 15% ON EVERYTHING ELSE*

ETHAN ALLEN®

— THE INTERIOR DESIGN DESTINATION —

*Discounts are taken off our regular prices. Prior reductions may have been taken. 20% savings offer includes upholstery cut yardage and COF. Offer excludes clearance, select new product introductions, table pads, drapery hardware, Outdoor Featured Deals, umbrellas and bases, flooring trims, and adjustable bed bases. Offer cannot be applied to prior purchases, pending deliveries, sales tax, shipping and delivery charges, gift cards, furniture replacement parts, or furniture protection plans and cannot be combined with any other savings offers, sales, discounts, coupons, or promotions except applicable financing offers. Offer ends April 30, 2025. Ask a designer or visit ethanallen.com for details.

§Restrictions apply. Ask a designer or visit ethanallen.com/platinum for details. Offer ends April 30, 2025.

All information is current as of April 1, 2025, and is subject to change without notice. We are not responsible for typographical errors. Please visit a Design Center or ethanallen.com for sale details and current information. Prices and services are optional for each retailer. All items may not be displayed at every Design Center. Final products may vary from display. Certain names and marks are proprietary and owned by Ethan Allen Global, Inc. ©2025 Ethan Allen Global, Inc. Danbury, CT. All rights reserved. Printed in USA (A).